

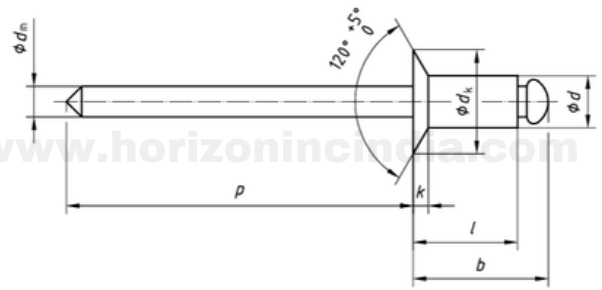

## Blind Rivet - Open End CSK Head

Material: Al/Al - ISO 15980

Part No: 4012L1



<b>d</b>	<b>2.4</b>	<b>3.2</b>	<b>4</b>	<b>4.8</b>
<b>dk</b>	<b>5</b>	<b>6.7</b>	<b>8.4</b>	<b>10.1</b>
<b>k</b>	<b>1</b>	<b>1.3</b>	<b>1.7</b>	<b>2</b>
<b>dm</b>	<b>1.55</b>	<b>2</b>	<b>2.45</b>	<b>2.95</b>
<b>p</b>	<b>25</b>	<b>25</b>	<b>27</b>	<b>27</b>
<b>b</b>	<b>lmax + 3.5</b>	<b>lmax + 4</b>	<b>lmax + 4</b>	<b>lmax + 4.5</b>
<b>Hole diameter</b>	<b>2.5-2.6</b>	<b>3.3-3.4</b>	<b>4.1-4.2</b>	<b>4.9-5</b>
<b>Tensile Strength</b>	<b>700 N</b>	<b>1200 N</b>	<b>2200 N</b>	<b>3100 N</b>
<b>Shear Strength</b>	<b>650 N</b>	<b>1100 N</b>	<b>1700 N</b>	<b>2900 N</b>
<b>Mandel Break Load</b>	<b>2000 N</b>	<b>4000 N</b>	<b>5800 N</b>	<b>7500 N</b>

### Part Numbers

Dimensions in mm

Diameter	Part number	Size	Grip Range
<b>2.4</b>	4012L1-24006	2.4x6	2.0-4.0
	4012L1-24008	2.4x8	4.0-6.0
	4012L1-24010	2.4x10	6.0-8.0
	4012L1-24012	2.4x12	8.0-9.5
<b>3.2</b>	4012L1-32006	3.2x6	2.0-3.5
	4012L1-32008	3.2x8	3.5-5.0
	4012L1-32010	3.2x10	5.0-7.0
	4012L1-32012	3.2x12	7.0-9.0
	4012L1-32016	3.2x16	9.0-13.0
	4012L1-32020	3.2x20	13.0-17.0

Diameter	Part number	Size	Grip Range
<b>4.0</b>	4012L1-40006	4x6	2.0-3.0
	4012L1-40008	4x8	3.0-5.0
	4012L1-40010	4x10	5.0-6.5
	4012L1-40012	4x12	6.5-8.0
	4012L1-40016	4x16	8.0-12.0
	4012L1-40020	4x20	12.0-16.0
<b>4.8</b>	4012L1-48008	4.8x8	2.5-4.0
	4012L1-48010	4.8x10	4.0-6.0
	4012L1-48012	4.8x12	6.0-8.0
	4012L1-48016	4.8x16	8.0-11.0
	4012L1-48020	4.8x20	11.0-15.0
	4012L1-48025	4.8x25	15.0-19.5

